

FORM NO. 1.

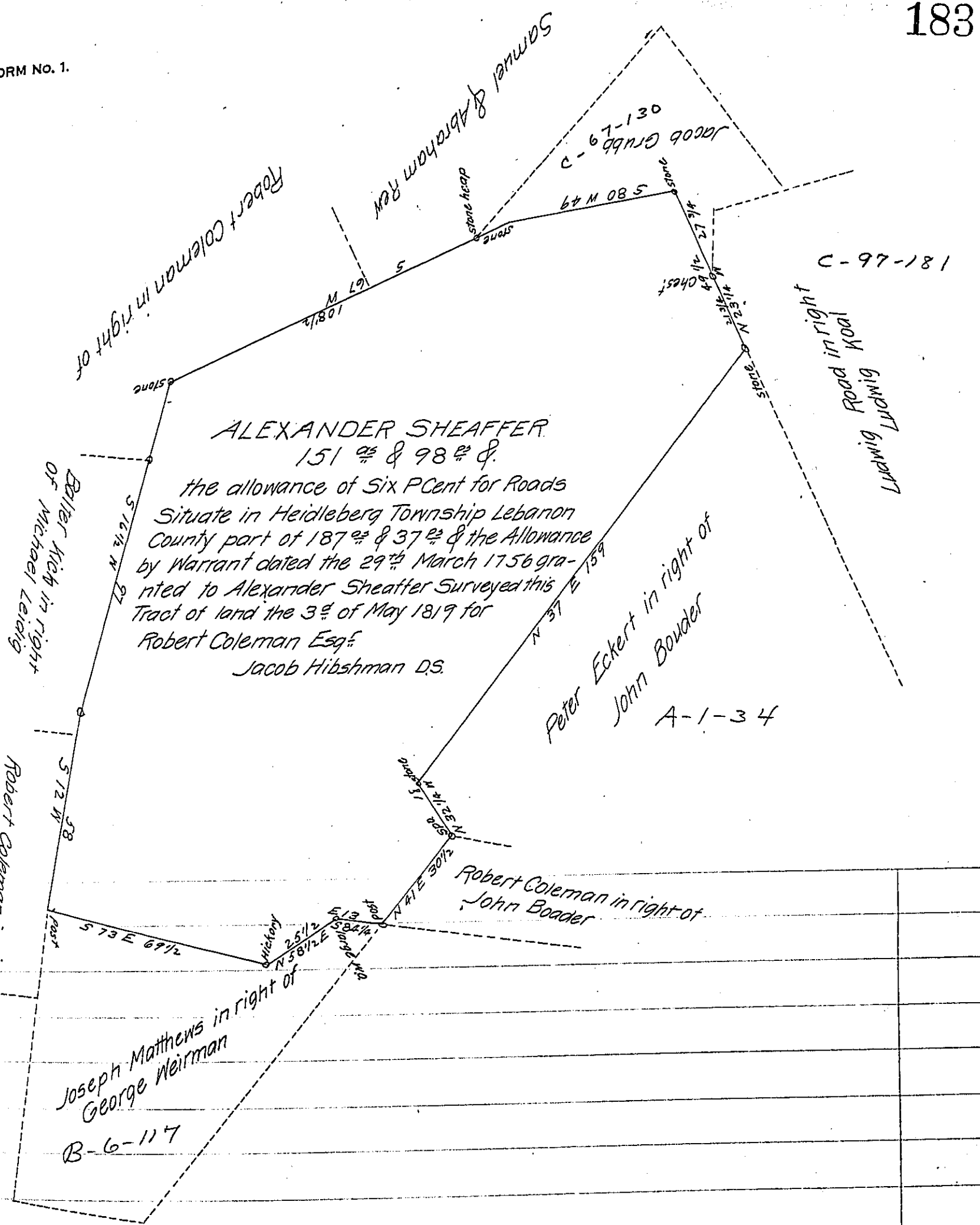

ALEXANDER SHEAFFER
 151^{ac} & 98^{ac} &
 the allowance of Six PCent for Roads
 Situate in Heidleberg Township Lebanon
 County part of 187^{ac} & 37^{ac} & the Allowance
 by Warrant dated the 29th March 1756 gra-
 nted to Alexander Sheaffer Surveyed this
 Tract of land the 3^d of May 1819 for
 Robert Coleman Esq:
 Jacob Hibshman D.S.

I Approve of the above Survey to be Accepted in the Surveyor Generals Office March 3^d 1824
 To Samuel Cochran Esq:
 Surveyor General } Levi Hollingworth D.S.

IN TESTIMONY that the above is a copy of the original remaining on file in
 the Department of Internal Affairs of Pennsylvania, made
 comformably to an Act of Assembly approved the 16th day of
 February 1833, I have hereunto set my hand and caused
 the Seal of said Department to be affixed at Harrisburg,
 this seventeenth day of January 1907

Edward P. Brown
 Secretary of Internal Affairs.